

Kort Propulsion Co Ltd



KT45 Tunnel Thruster Datasheet



Model	KT45	KT45L
Drive Motor	VOAC F12-40	VOAC F12-60
System Pressure –typical	280 bar	210 bar
Motor Pressure –nominal	255 bar	185 bar
Flow – nominal	63 ltr/min	94.5 ltr/min
Pump/Motor Power	29/27 kW	33/29 kW
Typical Pump for full thrust	75cc@900rpm	100cc@1000rpm
Propeller Diameter	375 mm	375 mm
Propeller RPM	1575	1575
Nominal Thrust	420 Kg	420 Kg
Tunnel	Grade A steel, 12.7mm thickness. Aluminium or GRP optional extra	
Wear Ring	Not required on this size of unit	
Drive Housing	SG Iron. Bronze or Aluminium optional extra	
Drive Shaft	Sealed bearing assembly, oil lubricated, 8 litre header tank supplied	
Propeller	Four blades, Manganese Bronze. Aluminium optional extra	

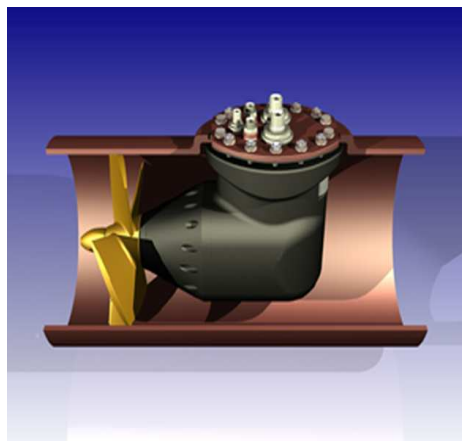

Hercules

SSA Shipbuilders & Shiprepairers Association

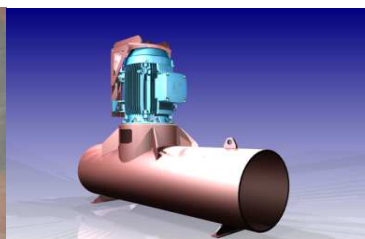

Kort Propulsion Co Ltd

Kort Propulsion Co Ltd | Registered in England 296528 VAT Registration No. 342 3166 81