

Kort Propulsion Co Ltd



KT300 Tunnel Thruster Datasheet



Model	KT300
Drive Motor	VOAC F11-250
System Pressure – typical	350 bar
Motor Pressure – nominal	325 bar
Flow - nominal	412.5 litres/min
Pump/Motor Power	240/223 kW
Typical Pump for full thrust	270cc@1500rpm
Propeller Diameter	750 mm
Propeller RPM	825
Nominal Thrust	2700 Kg
Tunnel	ST52 or Grade A steel, 22mm thickness.
Wear Ring	Stainless steel wear ring in way of propeller tips, 5mm thick
Drive Housing	SG Iron.
Drive Shaft	Sealed bearing assembly, oil lubricated, 8 litre header tank supplied
Propeller	Five blades, Manganese Bronze

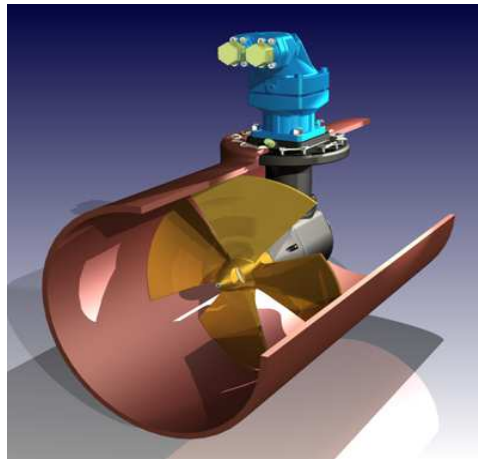

Hercules

SSA Shipbuilders & Shiprepairers Association

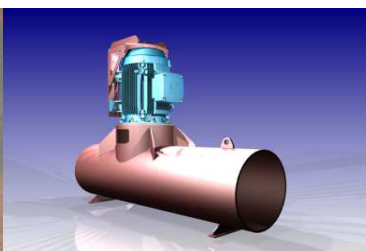

Kort Propulsion Co Ltd

Kort Propulsion Co Ltd | Registered in England 296528 VAT Registration No. 342 3166 81