

# Kort Propulsion Co Ltd



## KT30 Tunnel Thruster Datasheet



Model	KT30	KT30L
Drive Motor	VOAC F12-30	VOAC F12-40
System Pressure - typical	280 bar	210 bar
Motor Pressure - nominal	255 bar	185 bar
Flow - nominal	44 ltr/min	58.4 ltr/min
Pump/Motor Power	21/19 kW	20.4/18 kW
Typical Pump for full thrust	60cc@800rpm	75cc@800rpm
Propeller Diameter	375 mm	375 mm
Propeller RPM	1460	1460
Nominal Thrust	320 Kg	320 Kg
Tunnel	Grade A steel, 12.7mm thickness. Aluminium or GRP optional extra	
Wear Ring	Not required on this size of unit	
Drive Housing	SG Iron. Bronze or Aluminium optional extra	
Drive Shaft	Sealed bearing assembly, oil lubricated, 8 litre header tank supplied	
Propeller	Four blades, Manganese Bronze. Aluminium optional extra	

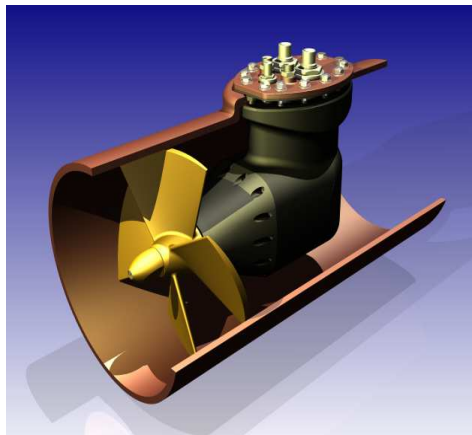

**Hercules**

**SSA** Shipbuilders & Shiprepairers Association

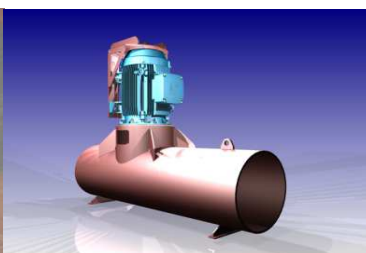

**Kort Propulsion Co Ltd**

Kort Propulsion Co Ltd | Registered in England 296528 VAT Registration No. 342 3166 81