

Kort Propulsion Co Ltd



KT250 Tunnel Thruster Datasheet



Model	KT250
Drive Motor	VOAC F11-250
System Pressure – typical	280 bar
Motor Pressure – nominal	255 bar
Flow - nominal	400 litres/min
Pump/Motor Power	187/170 kW
Typical Pump for full thrust	270cc@1550rpm
Propeller Diameter	750 mm
Propeller RPM	825
Nominal Thrust	2235 Kg
Tunnel	Grade A steel, 22mm thickness. Aluminium or GRP optional extra
Wear Ring	Stainless steel wear ring in way of propeller tips, 5mm thick
Drive Housing	SG Iron, Bronze or Aluminium optional extra
Drive Shaft	Sealed bearing assembly, oil lubricated, 8 litre header tank supplied
Propeller	Four blades, Manganese Bronze. Aluminium optional extra

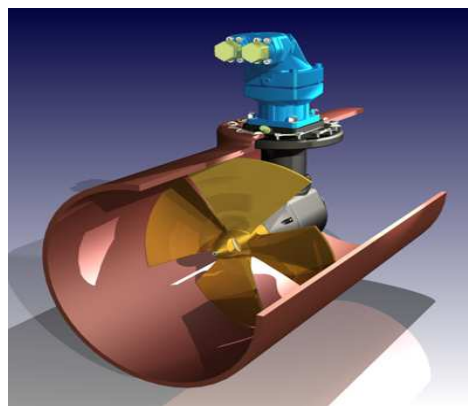

Hercules

SSA | Shipbuilders & Shiprepairers Association

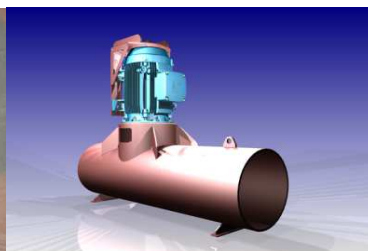

Kort Propulsion Co Ltd

Kort Propulsion Co Ltd | Registered in England 296528 | VAT Registration No. 342 3166 81