

Kort Propulsion Co Ltd



KT140 Tunnel Thruster Datasheet



Model	KT140	KT140L
Drive Motor	VOAC F11-150	VOAC F11-150
System Pressure - typical	280 bar	210 bar
Motor Pressure - nominal	255 bar	185 bar
Flow - nominal	124 ltr/min	124 ltr/min
Pump/Motor Power	58/53kW	43/38kW
Typical Pump for full thrust	130cc@1000rpm	130cc@1000rpm
Propeller Diameter	700 mm	700 mm
Propeller RPM	825	825
Nominal Thrust	970 Kg	830 Kg
Tunnel	Grade A steel, 17.5mm thickness. Aluminium or GRP optional extra	
Wear Ring	Stainless steel wear ring in way of propeller tips, 5mm thick	
Drive Housing	SG Iron. Bronze or Aluminium optional extra	
Drive Shaft	Sealed bearing assembly, oil lubricated, 8 litre header tank supplied	
Propeller	Four blades, Manganese Bronze. Aluminium optional extra	



Hercules

SSA Shipbuilders & Shiprepairers Association

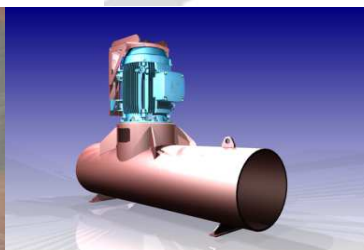

Kort Propulsion Co Ltd

Kort Propulsion Co Ltd | Registered in England 296528 | VAT Registration No. 342 3166 81