

# Kort Propulsion Co Ltd



## KT70 Tunnel Thruster Datasheet



Model	KT70	KT70L
Drive Motor	VOAC F12-60	VOAC F12-80
System Pressure – typical	280 bar	210 bar
Motor Pressure – nominal	255 bar	185 bar
Flow - nominal	66 ltr/min	88 ltr/min
Pump/Motor Power	31/28 kW	31/27 kW
Typical Pump for full thrust	75cc@900rpm	100cc@1000rpm
Propeller Diameter	505 mm	505 mm
Propeller RPM	1100	1100
Nominal Thrust	500 Kg	500 Kg
Tunnel	Grade A steel, 16mm thickness. Aluminium or GRP optional extra	
Wear Ring	Stainless steel wear ring in way of propeller tips, 5mm thick	
Drive Housing	SG Iron. Bronze or Aluminium optional extra	
Drive Shaft	Sealed bearing assembly, oil lubricated, 8 litre header tank supplied	
Propeller	Four blades, Manganese Bronze. Aluminium optional extra	

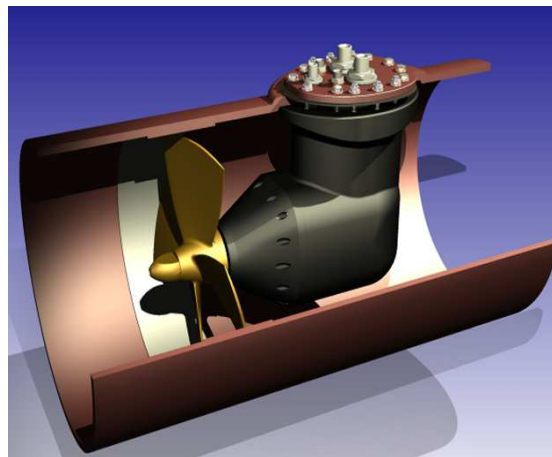

**Hercules**

**SSA** Shipbuilders & Shiprepairers Association

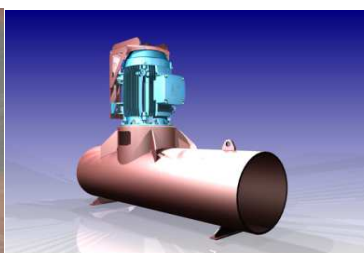

**Kort Propulsion Co Ltd**

Kort Propulsion Co Ltd | Registered in England 296528 VAT Registration No. 342 3166 81